

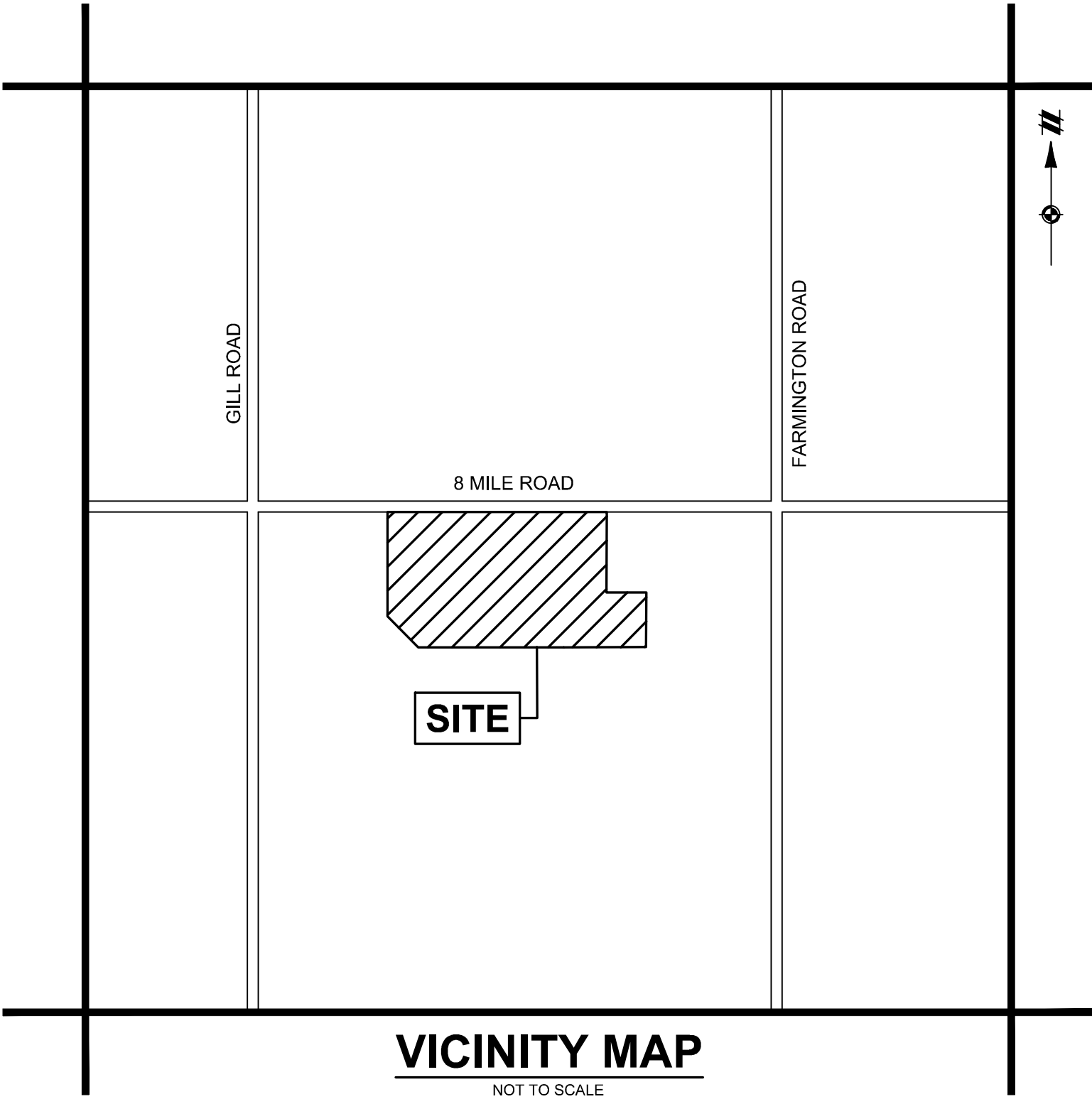



STORE D-615 EXPANSION  
33523 EIGHT MILE ROAD  
LIVONIA, MI 48152

# CONSTRUCTION PLANS



VICINITY MAP  
NOT TO SCALE



Know what's below.  
Call before you dig.

THE LOCATIONS OF EXISTING UNDERGROUND UTILITIES ARE SHOWN IN AN APPROXIMATE WAY ONLY AND HAVE NOT BEEN INDEPENDENTLY VERIFIED BY THE OWNER OR ITS REPRESENTATIVE. THE CONTRACTOR SHALL DETERMINE THE EXACT LOCATION OF ALL EXISTING UTILITIES BEFORE COMMENCING WORK, AND AGREES TO BE FULLY RESPONSIBLE FOR ANY AND ALL DAMAGES WHICH MIGHT BE OCCASIONED BY THE CONTRACTOR'S FAILURE TO EXACTLY LOCATE AND PRESERVE ANY AND ALL UNDERGROUND UTILITIES.

NOTICE: CONSTRUCTION SITE SAFETY IS THE SOLE RESPONSIBILITY OF THE CONTRACTOR. NEITHER THE OWNER NOR THE ENGINEER SHALL BE EXPECTED TO ASSUME ANY RESPONSIBILITY FOR SAFETY OF THE WORK, OF PERSONS ENGAGED IN THE WORK, OF ANY NEARBY STRUCTURES, OR OF ANY OTHER PERSONS.

COPYRIGHT © 2021 ATWELL LLC. NO REPRODUCTION SHALL BE MADE WITHOUT THE PRIOR WRITTEN CONSENT OF ATWELL LLC.



866.850.4200 [www.atwell-group.com](http://www.atwell-group.com)  
12745 23 MILE ROAD | SUITE 200  
SHELBY TOWNSHIP, MI 48315  
(586) 786-3600



## DEVELOPMENT TEAM

### APPLICANT

THE KROGER CO. OF MICHIGAN  
40393 GRAND RIVER AVE.  
NOVI, MI 48375  
CONTACT: GARETT FOLEY  
PHONE: 567-204-8518  
EMAIL: [garett.foley@kroger.com](mailto:garett.foley@kroger.com)

### OWNER

NORTHBRIDGE LIVONIA, LLC  
28470 THIRTEEN MILE ROAD, STE 200  
FARMINGTON HILLS, MI 48334  
CONTACT: WILLIAM EISENBERG  
PHONE: 248-538-6363  
EMAIL: [weisenberg@grandsakwa.com](mailto:weisenberg@grandsakwa.com)

### CIVIL ENGINEER

ATWELL, LLC  
12745 23 MILE ROAD, SUITE 200  
SHELBY TWP., MI 48315  
CONTACT: MICHAEL McPHERSON  
PHONE: (586) 786-9800  
EMAIL: [mmcpherson@atwell-group.com](mailto:mmcpherson@atwell-group.com)

### ARCHITECT

CR ARCHITECTURE & DESIGN  
600 VINE STREET, SUITE 2210  
CINCINNATI, OH 45202  
CONTACT: ANTHONY FREY  
PHONE: (513) 721-8080  
EMAIL: [a.frey@cr-architects.com](mailto:a.frey@cr-architects.com)

## GOVERNING AGENCIES / UTILITY CONTACTS

### PLANNING

CITY OF LIVONIA  
33000 CIVIC CENTER DRIVE  
LIVONIA, MI 48154  
CONTACT: MARK TAORMINA  
PHONE: 734-466-2292  
EMAIL: [mtaormina@livonia.gov](mailto:mtaormina@livonia.gov)

### ENGINEERING

CITY OF LIVONIA  
12973 FARMINGTON ROAD  
LIVONIA, MI 48150  
CONTACT: LOUAI YOKHANNA  
PHONE: 734-466-2574  
EMAIL: [lyoukhanna@livonia.gov](mailto:lyoukhanna@livonia.gov)

## PARCEL DESCRIPTION

SCHEDULE A EXHIBIT "A" LEGAL DESCRIPTION PER COMMITMENT FOR TITLE INSURANCE ISSUED BY FIDELITY NATIONAL TITLE INSURANCE COMPANY, COMMITMENT NO.: GLT1800451, COMMITMENT DATE: NOVEMBER 15, 2018  
LAND SITUATED IN THE CITY OF LIVONIA, COUNTY OF WAYNE AND STATE OF MICHIGAN, DESCRIBED AS FOLLOWS:

PARCEL 1:  
COMMENCING AT THE NORTH 1/4 CORNER OF SECTION 4, TOWN 1 SOUTH, RANGE 9 EAST, CITY OF LIVONIA, WAYNE COUNTY, MICHIGAN; THENCE SOUTH 00 DEG. 04' 56" WEST 60.00 FEET; THENCE NORTH 89 DEG. 41' 00" EAST 680.42 FEET ALONG THE SOUTH RIGHT-OF-WAY LINE OF EIGHT MILE ROAD (93 FOOT WIDE) FOR A PLACE OF BEGINNING; THENCE CONTINUING NORTH 89 DEG. 41' 00" EAST 462.24 FEET ALONG THE SOUTH RIGHT-OF-WAY LINE OF SAID EIGHT MILE ROAD; THENCE SOUTH 00 DEG. 19' 00" EAST 180.00 FEET; THENCE NORTH 89 DEG. 41' 00" EAST 402.36 FEET; THENCE SOUTH 00 DEG. 19' 00" EAST 30.00 FEET; THENCE NORTH 89 DEG. 41' 04" EAST 14.50 FEET; THENCE SOUTH 00 DEG. 19' 19" EAST 464.94 FEET; THENCE THE FOLLOWING THREE (3) COURSES ALONG THE NORTHERLY AND EASTERLY LINES OF ON THE POND CONDOMINIUM, W.C.C.P. NO. 593, MASTER DEED RECORDED AT LIBER 33127, PAGE 556, WAYNE COUNTY RECORDS: SOUTH 89 DEG. 40' 41" WEST 725.60 FEET (RECORDED AS SOUTH 89 DEG. 41' 00" WEST 725.99 FEET), NORTH 45 DEG. 19' 00" WEST 216.94 FEET, AND NORTH 00 DEG. 19' 59" WEST 521.60 FEET (RECORDED AS SOUTH 00 DEG. 19' 00" EAST 521.59 FEET) TO THE PLACE OF BEGINNING, BEING A PART OF THE NORTHEAST 1/4 OF SAID SECTION 4, CITY OF LIVONIA, WAYNE COUNTY, MICHIGAN.

PARCEL 2:  
COMMENCING AT THE NORTH 1/4 CORNER OF SECTION 4, TOWN 1 SOUTH, RANGE 9 EAST, CITY OF LIVONIA, WAYNE COUNTY, MICHIGAN; THENCE SOUTH 00 DEG. 04' 56" WEST 60.00 FEET; THENCE NORTH 89 DEG. 41' 00" EAST 1142.66 FEET ALONG THE SOUTH RIGHT-OF-WAY LINE OF EIGHT MILE ROAD (93 FOOT WIDE) FOR A PLACE OF BEGINNING; THENCE CONTINUING NORTH 89 DEG. 41' 00" EAST 156.00 FEET ALONG THE SOUTH RIGHT-OF-WAY LINE OF SAID EIGHT MILE ROAD; THENCE SOUTH 00 DEG. 19' 00" EAST 180.00 FEET; THENCE NORTH 89 DEG. 41' 00" WEST 156.00 FEET; THENCE NORTH 00 DEG. 19' 00" WEST 180.00 FEET TO THE PLACE OF BEGINNING, BEING A PART OF THE NORTHEAST 1/4 OF SAID SECTION 4, CITY OF LIVONIA, WAYNE COUNTY, MICHIGAN.

PARCEL 3:  
COMMENCING AT THE NORTH 1/4 CORNER OF SECTION 4, TOWN 1 SOUTH, RANGE 9 EAST, CITY OF LIVONIA, WAYNE COUNTY, MICHIGAN; THENCE SOUTH 00 DEG. 04' 56" WEST 60.00 FEET; THENCE NORTH 89 DEG. 41' 00" EAST 1298.67 FEET ALONG THE SOUTH RIGHT-OF-WAY LINE OF EIGHT MILE ROAD (93 FOOT WIDE) FOR A PLACE OF BEGINNING; THENCE CONTINUING NORTH 89 DEG. 41' 00" EAST 246.36 FEET ALONG THE SOUTH RIGHT-OF-WAY LINE OF SAID EIGHT MILE ROAD; THENCE SOUTH 00 DEG. 19' 00" EAST 180.00 FEET; THENCE NORTH 89 DEG. 41' 00" WEST 246.36 FEET; THENCE NORTH 00 DEG. 19' 00" WEST 180.00 FEET TO THE PLACE OF BEGINNING, BEING A PART OF THE NORTHEAST 1/4 OF SAID SECTION 4.

PARCEL 4:  
COMMENCING AT THE NORTH 1/4 CORNER OF SECTION 4, TOWN 1 SOUTH, RANGE 9 EAST, CITY OF LIVONIA, WAYNE COUNTY, MICHIGAN; THENCE SOUTH 00 DEG. 04' 56" WEST 60.00 FEET; THENCE NORTH 89 DEG. 41' 00" EAST 1545.03 FEET ALONG THE SOUTH RIGHT-OF-WAY LINE OF EIGHT MILE ROAD (93 FOOT WIDE) FOR A PLACE OF BEGINNING; THENCE CONTINUING NORTH 89 DEG. 41' 00" EAST 229.26 FEET ALONG THE SOUTH RIGHT-OF-WAY LINE OF SAID EIGHT MILE ROAD; THENCE SOUTH 00 DEG. 02' 37" WEST 210.00 FEET; THENCE NORTH 89 DEG. 41' 04" WEST 227.94 FEET; THENCE NORTH 00 DEG. 19' 00" WEST 210.00 FEET TO THE PLACE OF BEGINNING, BEING A PART OF THE NORTHEAST 1/4 OF SAID SECTION 4.

PARCEL 5:  
COMMENCING AT THE NORTH 1/4 CORNER OF SECTION 4, TOWN 1 SOUTH, RANGE 9 EAST, CITY OF LIVONIA, WAYNE COUNTY, MICHIGAN; THENCE SOUTH 00 DEG. 04' 56" WEST 60 FEET; THENCE NORTH 89 DEG. 41' 00" EAST 1559.51 FEET; THENCE SOUTH 00 DEG. 19' 19" EAST 210.00 FEET TO THE PLACE OF BEGINNING; THENCE NORTH 89 DEG. 41' 00" EAST 213.44 FEET; THENCE SOUTH 00 DEG. 02' 37" WEST 191.94 FEET; THENCE NORTH 89 DEG. 42' 08" EAST 199.96 FEET (NORTH 89 DEG. 41' 00" EAST 200.00 FEET RECORDED); THENCE SOUTH 00 DEG. 01' 48" WEST 272.91 FEET MEASURED (SOUTH 00 DEG. 03' 10" WEST 273.01 FEET RECORDED) ALONG A LINE PARALLEL WITH AND 660.00 FEET WEST OF THE EAST LINE OF SAID SECTION 4; THENCE SOUTH 89 DEG. 40' 41" WEST 410.50 FEET MEASURED (410.89 FEET RECORDED); THENCE NORTH 00 DEG. 19' 19" WEST 464.95 FEET TO THE PLACE OF BEGINNING.

## NOTES TO CONTRACTOR

- THE SITE WORK FOR THIS PROJECT SHALL MEET OR EXCEED THE KROGER SITE WORK SPECIFICATIONS.
- ALL WORK SHALL BE DONE IN ACCORDANCE WITH LIVONIA STANDARDS.
- ALL SYSTEMS, PRODUCTS, AND INSTALLATIONS SHALL BE GUARANTEED AGAINST ANY DEFECTS FOR A PERIOD OF ONE (1) FROM THE STORE OPENING DATE OF THE EXPANSION. CORRECTION OR REPLACEMENT OF DEFECTIVE MATERIALS AND WORKMANSHIP SHALL BE THE RESPONSIBILITY OF THE CONTRACTOR.
- ALL DISTURBANCE ONTO THE ADJACENT PARCELS SHALL BE FULLY RESTORED WITHIN 15-DAYS AFTER THE WORK ON THE ADJACENT PARCELS HAS BEEN COMPLETED.

## FLOODPLAIN NOTE

PER THE FEDERAL EMERGENCY MANAGEMENT AGENCY (FEMA) MAP NO. 26163C0227E, DATED 02-12-2012, THE SITE LIES WITHIN ZONE X WHICH ARE AREAS DETERMINED TO BE OUTSIDE OF THE 0.2% ANNUAL CHANCE FLOODPLAIN.

## WETLANDS

THE ARE NO EXISTING WETLANDS LOCATED ON-SITE.

## PERMIT MATRIX

TYPE	ISSUED BY	STATUS
SITE PLANS	CITY OF LIVONIA	APPROVED
SESC	CITY OF LIVONIA	PENDING
ENGINEERING	CITY OF LIVONIA	APPROVED

## SHEET INDEX

- C0.0 COVER
- C0.1 NOTES
- C0.2 CITY OF LIVONIA UTILITY CONTACTS
- CD1.0 DEMOLITION PLAN
- C1.2.1 SESC PHASE I
- C1.2.2 SESC PHASE II
- C1.2.3 SESC NOTES & DETAILS
- C1.3.1 OVERALL LAYOUT PLAN
- C1.3.2 LAYOUT PLAN
- C1.3.3 LAYOUT PLAN
- C1.3.4 PICKUP AREA DETAIL
- C1.4.1 OVERALL GRADING PLAN
- C1.4.2 GRADING PLAN
- C1.4.3 GRADING PLAN
- C1.4.4 GRADING PLAN
- C1.5.1 STORMWATER CALCULATIONS & DRAINAGE AREAS
- C1.5.2 STORM SEWER PLAN
- C1.5.3 OUTLET RESTRICTOR DETAILS
- C1.5.4 UNDERGROUND DETENTION DETAILS
- C1.5.5 PRE TREATMENT UNIT DETAILS
- C1.6.1 UTILITY PLAN
- C1.6.2 UTILITY PLAN
- C1.6.3 SANITARY BASIS OF DESIGN
- C1.6.4 PROFILES - STORM SEWER
- C1.6.5 PROFILES - SANITARY
- C1.6.6 PROFILES - SANITARY
- C1.7.1 PHASE I TEMPORARY TRAFFIC CONTROL PLAN
- C1.7.2 PHASE II TEMPORARY TRAFFIC CONTROL PLAN
- LS1.0 LANDSCAPE PLAN
- LS1.1 LANDSCAPE DETAILS
- C5.0 DETAILS
- C5.1 DETAILS

### ATTACHED PLANS

ALTA SURVEY  
CITY OF LIVONIA SANITARY SEWER DETAILS  
CITY OF LIVONIA STORM SEWER DETAILS  
CITY OF LIVONIA WATERMAIN DETAILS  
CITY OF LIVONIA SESC DETAILS

THE KROGER COMPANY

STORE D-615 EXPANSION

SITE PLANS

CITY OF LIVONIA

WAYNE COUNTY, MICHIGAN

DATE

JULY 13, 2021

REVISIONS/SUBMITTALS

07-13-2021 SUBMIT TO CITY

10-27-2021 0TB

02-01-2022 REV PER CITY

03-25-2022 REV PER CITY

05-10-2022 BULLETIN 1

NO SCALE

NO SCALE

DRAWN BY: EM

CHECKED BY: EM

PROJECT MANAGER: MMC

JOB #: 18003949

SHEET NO.

C0.0